



CITY OF TAMPA

Bob Buckhorn, Mayor

CONTRACT ADMINISTRATION DEPARTMENT

David L. Vaughn, AIA, Director

ADDENDUM NO. 2

DATE: December 12, 2014

Contract 14-C-00056; Harbour Island Roadway Surface Replacement

Bidders on the above referenced project are hereby notified that the following addendum is made to the Contract Documents. BIDS TO BE SUBMITTED SHALL CONFORM TO THIS NOTICE.

Item 1: Insert into the plans set the attached Sheet S0.2.

All other provisions of the Contract Documents and Specifications not in conflict with this Addendum shall remain in full force and effect. Questions are to be e-mailed to Contract Administration@tampagov.net.

Jim Greiner

Jim Greiner, P.E., Contract Management Supervisor

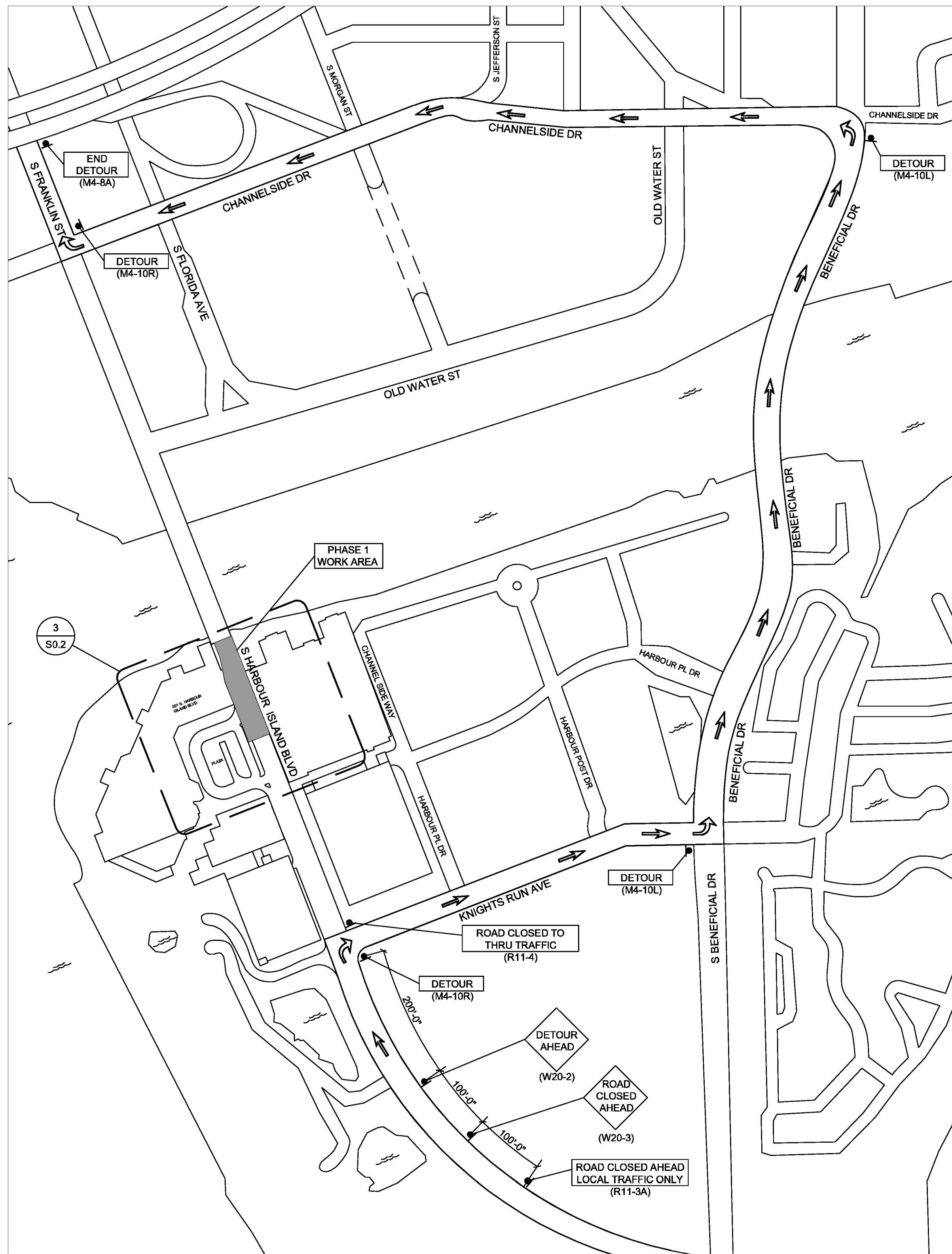

MOT PLAN - CONSTRUCTION PHASE 1 -
TRAFFIC HEADING SOUTH ON S. FRANKLIN ST.

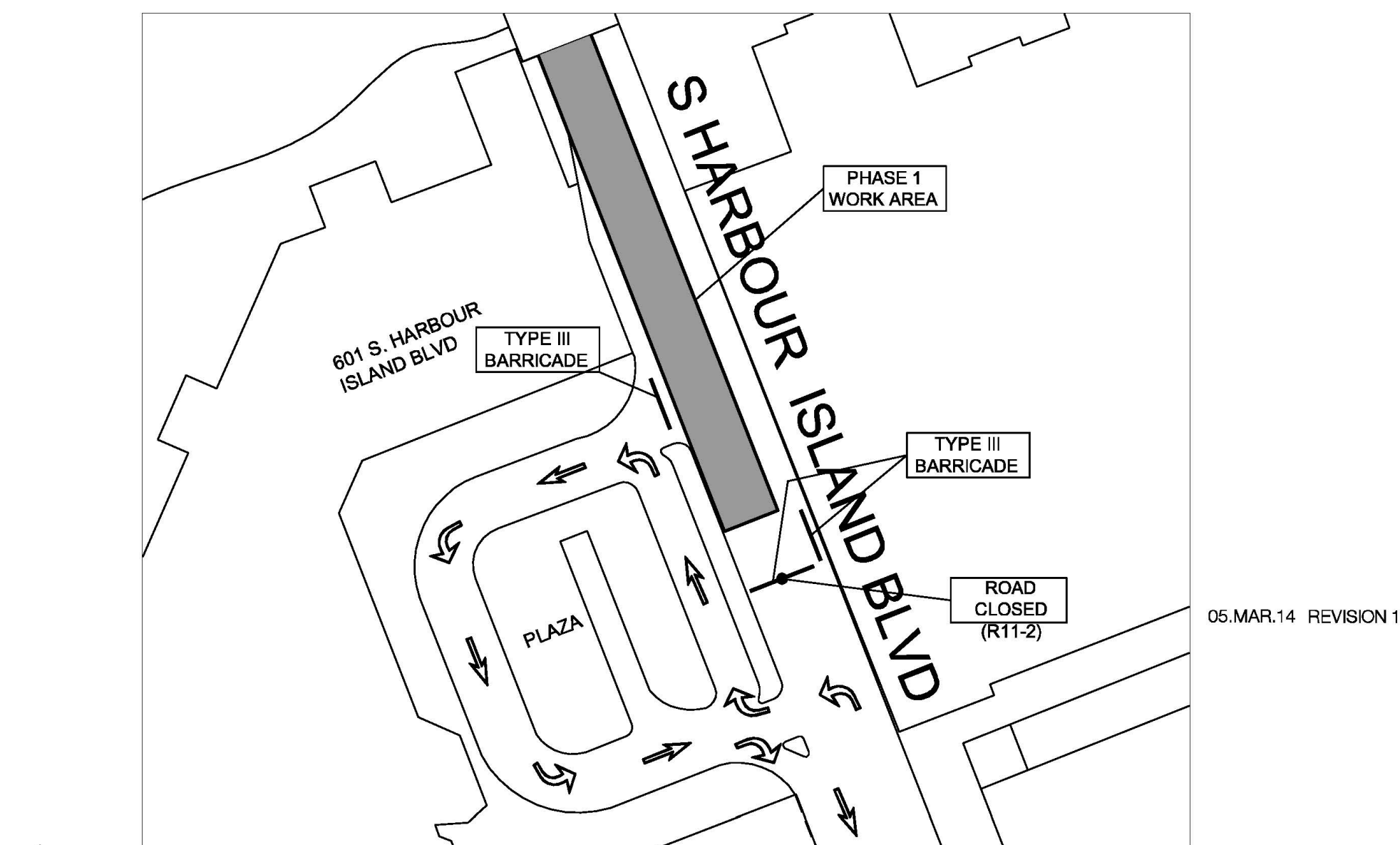

ENLARGED - LOCAL TRAFFIC MOT

MAINTENANCE OF TRAFFIC NOTES:

1. CONTRACTOR SHALL BE RESPONSIBLE FOR PROVIDING AND MAINTAINING ALL BARRICADES AND WARNING SIGNS IN CONFORMANCE WITH THE MANUAL ON UNIFORM TRAFFIC CONTROL DEVICES (M.U.T.C.D.) MOST RECENT EDITION AND ALL CITY OF TAMPA REGULATIONS DURING CONSTRUCTION.
2. CONTRACTOR SHALL PROVIDE ACCESS TO ALL BUSINESS AND PRIVATE-RESIDENTIAL PROPERTIES ALONG THIS PROJECT AT ALL TIMES DURING CONSTRUCTION.
3. CONTRACTOR SHALL PROVIDE BUSINESS ACCESS SIGNS TO DIRECT LOCAL TRAFFIC TO BUSINESSES DURING CONSTRUCTION. CONTRACTOR SHALL COORDINATE LOCATION OF SIGNS WITH HCSA.
4. CONTRACTOR SHALL COVER OR REMOVE ALL EXISTING SIGNS WHICH ARE IN CONFLICT WITH THE CONSTRUCTION SIGNS AND MARKINGS. IF REMOVED, SIGNS SHALL BE PROPERLY STORED IN A SAFE PLACE UNTIL THE CONSTRUCTION HAS BEEN COMPLETED AND THEN REINSTALLED.

NOTE:

RE-ROUTE TRAFFIC FROM SOUTH FRANKLIN STREET ONTO OLD WATER STREET EASTBOUND, TO CHANNELSIDE DRIVE EASTBOUND, TO BENEFICIAL DRIVE SOUTHBOUND, TO KNIGHTS RUN AVENUE WESTBOUND AND ONTO SOUTH HARBOUR ISLAND BOULEVARD SOUTHBOUND.

HARBOUR ISLAND ROADWAY SURFACE REPLACEMENT

CITY OF TAMPA

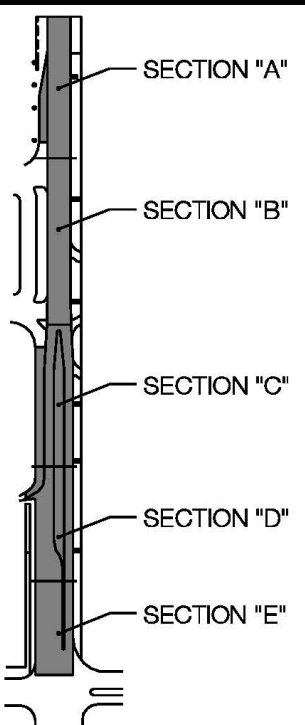
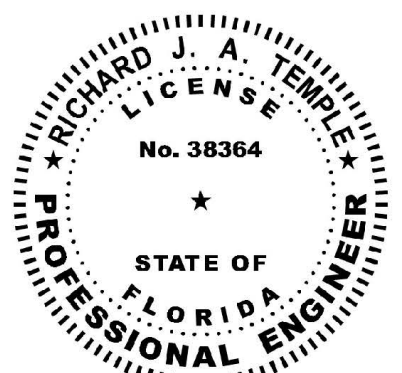
[illegible]

PHASE 1 MOT PLANS