

# City of Tampa Nighttime Walking Tour: Tampa's Public Art After Dark

This walk is approximately 2.6 miles and takes about 90 minutes at a moderate to quick pace.



## 1 Glazer Children's Museum

At the main entrance of the Glazer Children's museum is an 80-foot mosaic by artist Mari Gardner titled "Spiral Fantasia." As children enter the museum, they are able to touch the tiles and see their reflections in the fractured mirrored pieces. The spiral-within-a-spiral design, conveys discovery, imagination and playful expression.

## 2 Murals at Poe Garage

The "Stay Curious" series of murals that wrap the perimeter of the Poe Parking Garage celebrates and promotes the creative culture of Tampa Bay. The meaningful message and designs by artists Bask & Tes One encourage visitors to continue learning and experience the arts.

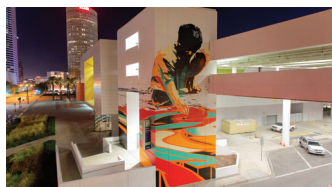

## 3 Portal

The Portal consists of pedestrian friendly, digital monitors that are programmed with new media art and digital educational exhibitions. Content on the environment, history and culture is presented through the lens of the arts.

## 4 Tampa Museum of Art

The Tampa Museum of Art building was designed by Stanley Saitowitz and features a lighted façade by renowned artist, Leo Villareal. The artwork, "Sky" is an LED program that showcases movement and light; a sequencing of patterns created by the artist's custom coded software that merge as a whole and result in random templates of flash, fade, trail and color. The matrix of 144 four-foot LED illuminators display a visual language of non-repeating patterns.

## 5 Bridges

Lights On Tampa: Agua Luces is an initiative that has permanently lit five landmark bridges with low energy LED lighting. The impactful lighting, created by lighting artist, Tracey Dear, is on from sunset to sunrise and changes color every 30 seconds. The design provides a signature vista for the City of Tampa. Walking south down the Riverwalk, you'll walk under Kennedy Boulevard Bridge. On your return, the Riverwalk will take you under Platt Street Bridge, Selmon Expressway Overpass, Brorein Street Bridge. The lighting of the the CSX Railroad Bridge Can be seen if you look north up the Hillsborough River.

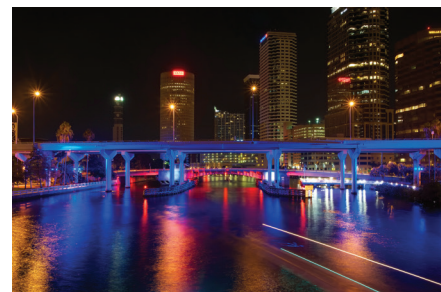

# City of Tampa Nighttime Walking Tour: Tampa's Public Art After Dark



#tampapublicart

This walk is approximately 2.6 miles and takes about 90 minutes at a moderate to quick pace.



## 6 Mac Dill Park Plaques

These artist-designed plaques mounted on granite plinths, illustrate the significance of MacDill Airforce base to Tampa and its history.

## 7 Whiting Street - Gates

These gates were designed by St Petersburg artist, Frank Strunk, for US Ameribank. This is an example of how private businesses integrate public art into their downtown offices, and or residential developments – In this case, the artist's design has kept in the spirit of the business, a bank, through the use of the imagery of United States currency.



## 8 Streetcar Stop: Franklin Street

This is the start of the line for the TECOLine Streetcar, which takes riders through Channel District all the way to Ybor City!

In the spirit of the City's Lights On Tampa program, artist James Woodfill added programmable LEDs that gently shift colors after the sun goes down.



## 9 CAMLS

Also in the spirit of Lights On Tampa, as part of their Public Art in Private Development requirement, the USF CAMLS facility (Center for Advanced Medical Learning & Simulation), commissioned a Swedish artist to light the scrim of their building – similar to the Tampa Museum of Art. Beginning at dusk, their building is illuminated with a bold wash of color – sometimes you can even see USF Bulls colors (green and gold) in the circulation.



## 10 Frames on Franklin

This installation is called Frames on Franklin. The Tampa Downtown Partnership wanted to beautify this area of downtown and the Art Programs Division assisted by commissioning artist, Tim Boatright, to create the designs which the Partnership used to frame, and place on this wall. Keep an eye out – you'll also see these designs on traffic signal boxes throughout downtown.

# City of Tampa Nighttime Walking Tour: Tampa's Public Art After Dark

This walk is approximately 2.6 miles and takes about 90 minutes at a moderate to quick pace.



## 11 Franklin St. at Convention Center

This sculpture, Zig Zag, by Linda Howard welcomes pedestrians to this entrance to the Tampa Riverwalk, and the Sail Pavilion, a popular bar for residents and visitors. Zig Zag has been in the collection for many years – it is one of the first in the collection – and the artist recently refurbished it by having it powder coated white.

## 12 Riverwalk

As you walk along the Riverwalk, you'll see bronze busts peppered along the 2.4 mile route. These works, by Florida artist, Steve Dickey, feature icons of Tampa's past: From a representative of the Mocoso tribe from thousands of years ago, to Vicente Martinez-Ybor, who established his cigar industry east of downtown, now known as Ybor City.

## 13 Ceramic Seatbacks

The imagery of the ceramics that are embedded into the seatbacks are centered on the historic relevance of the site, Tampa's industry and the downtown. Artist Peter King pulled from a wealth of resources including old maps, photographs, and textile patterns.



## 14 Cenotaph & Ceremonial Space

Cenotaph literally means bones buried elsewhere - this is a space for reflection of the site. This site features bronze text panels that recount the complex history of the site at the time of Fort Brooke, which served as a major outpost during all three Seminole Indian Wars and the Civil War. The fort also played a part in the development of the village of Tampa.

The panels include Seminole song of removal, maps, and statements by contemporary historians. Ceremonial Space, by Apache artist Bob Haozous, is a thoughtful tribute to the Seminole Indians. Underneath the sculpture, there are bricks in 4 quadrants indicating cardinal directions with culturally appropriate colors (which are also found in the flags of the Seminole Tribe of Florida) and the sculpture incorporates imagery of the cypress trees that were used for foundations of Seminole chickee homes.





# City of Tampa Nighttime Walking Tour: Tampa's Public Art After Dark

This walk is approximately 2.6 miles and takes about 90 minutes at a moderate to quick pace.

#tampapublicart



## 15 Riverwall

The Riverwall by artist Bruce Marsh serves as an iconic entrance to the south end of the Tampa Riverwalk. Marsh photographed hundreds of images of the Hillsborough River to create a quilt of images to celebrate and document the River.



## 16 Lightning

The Amalie Arena is home to the Tampa Bay Lightning, and home to the tallest sculpture in Florida, "Lightning", by Jonathan Borofsky. Borofsky is also known for his "Hammering Man" series installed across the globe in the 70s and 80s. This artwork was installed when the Arena was built in the late 90s. "Lightning" is approximately 95' tall, and serves as a meeting space for visitors to the arena.



## 17 Dick Greco

Dick Greco served as Tampa's Mayor twice, First Term: October 1, 1967 - April 1, 1974, Second Term: April 1, 1995 - April 1, 2003. While in his second term, Greco played a vital role in bringing the modern streetcar system to the city and revitalizing the Channel District. This sculpture of Mayor Greco, can be found at the downtown TECOLine Streetcar stop that takes you from downtown to the Channel District and Ybor.



**To return to the beginning of the tour, simply hop back on the Tampa Riverwalk behind The Sail and walk north.**

Tampa Public Art is a program of the City of Tampa, Art Programs Division. The mission of the Division is the bring free access to artistic excellence.

[tampagov.net/Arts](http://tampagov.net/Arts)