

# Bay to Bay & MacDill, Tampa

Kamani Samuel  
Streets and Blocks  
Fall 2020



UNIVERSITY of  
**SOUTH FLORIDA**  
College of The Arts

## PROS

- Active business
- Near Highway
- Open space

## CONS

- Trees for shading
- Sidewalks
- Abandoned Spaces
- Parking

# BAY TO BAY PRESENT LAND

3251 W Bay to Bay Blvd



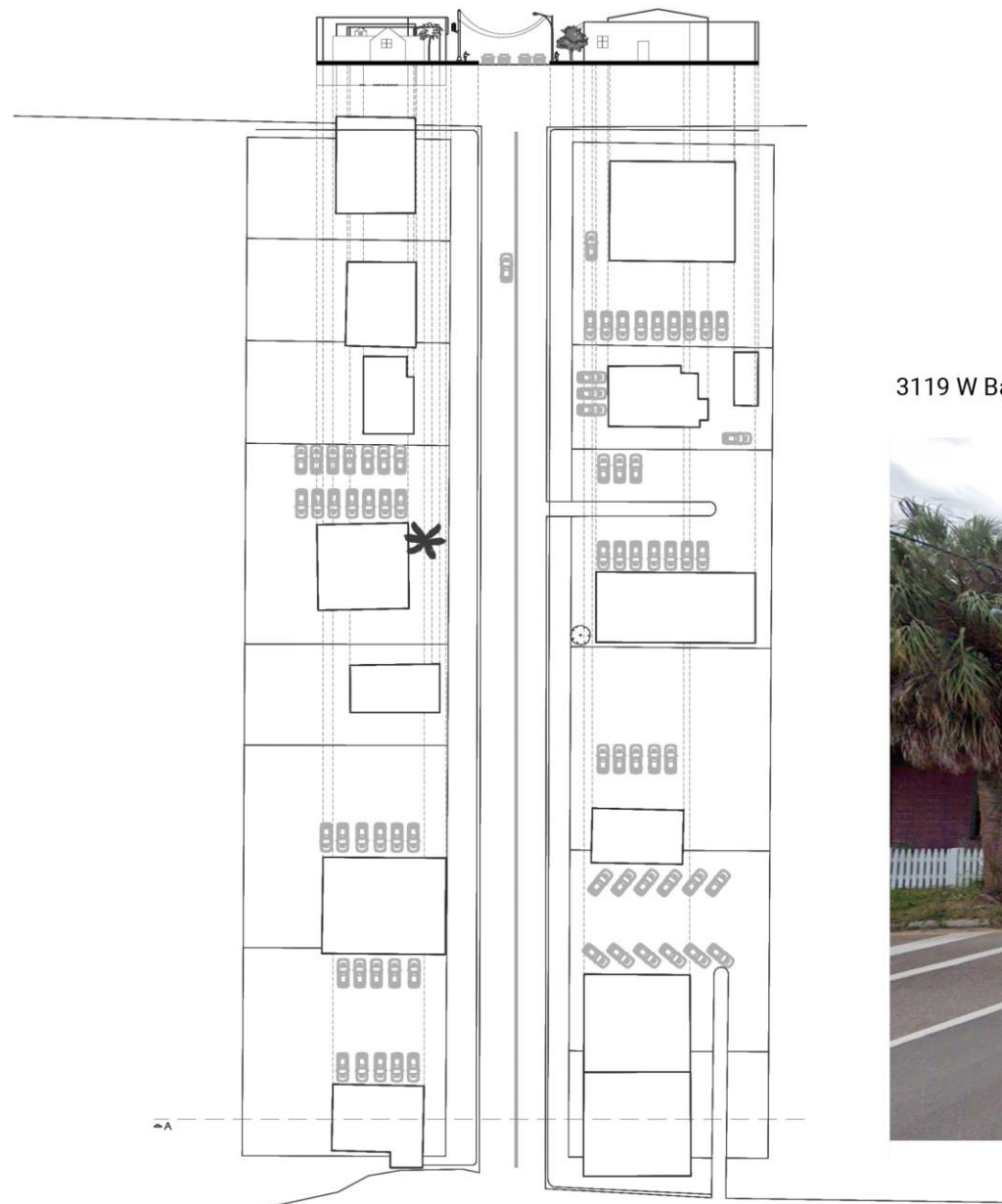

3119 W Bay to Bay Blvd



# MAC DILL

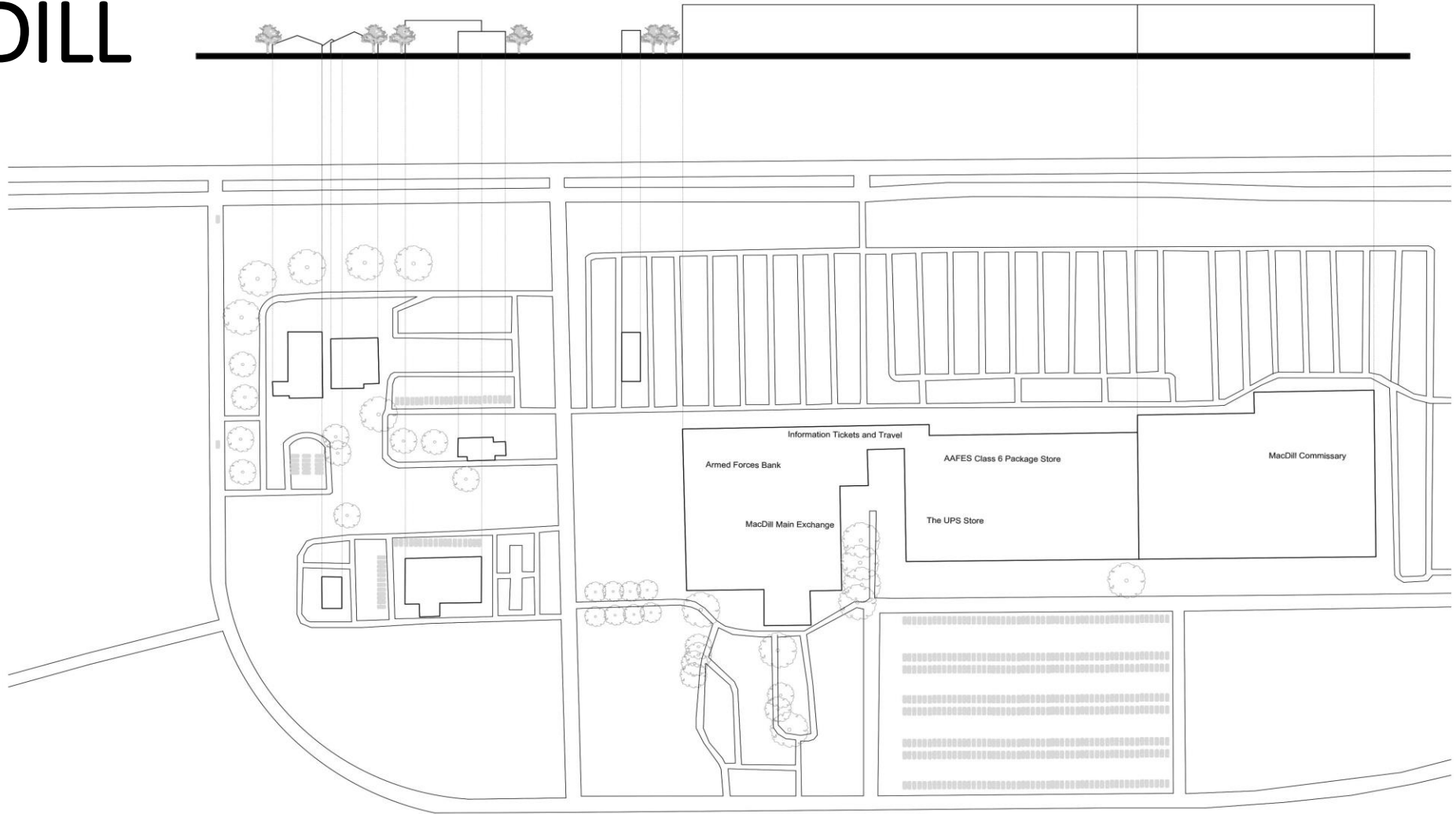



# VISION AND FRAMEWORK

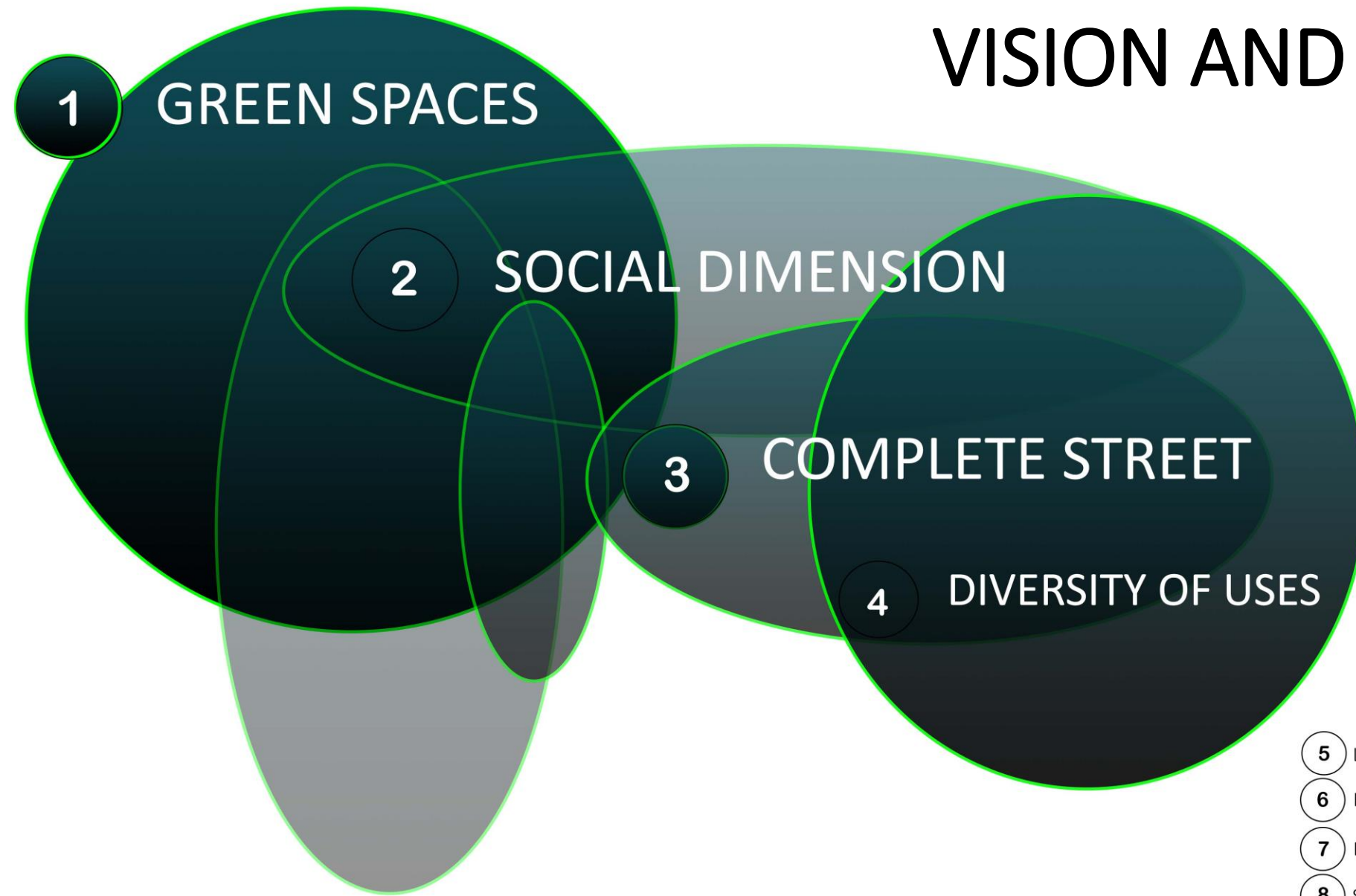

- 5 Local Identity
- 6 Human Scale
- 7 Lighting
- 8 Stimulating the local economy
- 9 Active facades
- 10 Social participation

# GREEN SPACES

Including more palm trees to the business and retail streets of Bay to Bay. Help in reduction of the energy costs of cooling buildings effectively. For Mac Dill, open space provides recreational areas for residents and helps to enhance the beauty and environmental quality of neighborhoods.

- Include more trees for its area
- Little parks for sitting
- Plants with information (knowledge)
- Playgrounds

# COMPLETE STREETS

- Creating more space for pedestrians can feel safer. Transportation is an issue in Bay to Bay and finding an area in space that's can benefit its surrounding. Wherever possible, public areas should be thought of following the principles of Complete Streets and "shared spaces." The Complete Streets concept defines streets designed to ensure the safe circulation of all users—pedestrians, cyclists, drivers and users of public transport.
  - Wider Sidewalks
  - The practice of on-street parking stands in stark contrast to conventional practices that use allotted spaces and garages.
  - Curb intensions



# SOCIAL DIMENSION & URBAN VITALITY

- Pathways and organization is needed in Bay to Bay. Sitting areas allows pedestrians to spend some time in the area. As an aggregator of people, public space has influence over the social dimension. Wide, accessible streets, squares, parks, sidewalks, bike paths and urban furniture stimulate interaction between people and the environment, generate a positive use of space and increase urban vitality.
- Include Bike paths
- Decrease the size of cars on road
- Parks in areas available

# LOCAL IDENTITY

- Aggravate pedestrians to create experiences between building with art pieces. This relates directly to how active are local communities, including its artists and cultural workers, as it is important to ensure that Civil Society and its cultural values are enhanced.
- More public art that express its business

# 3251 W Bay to Bay & 3119 W Bay to Bay

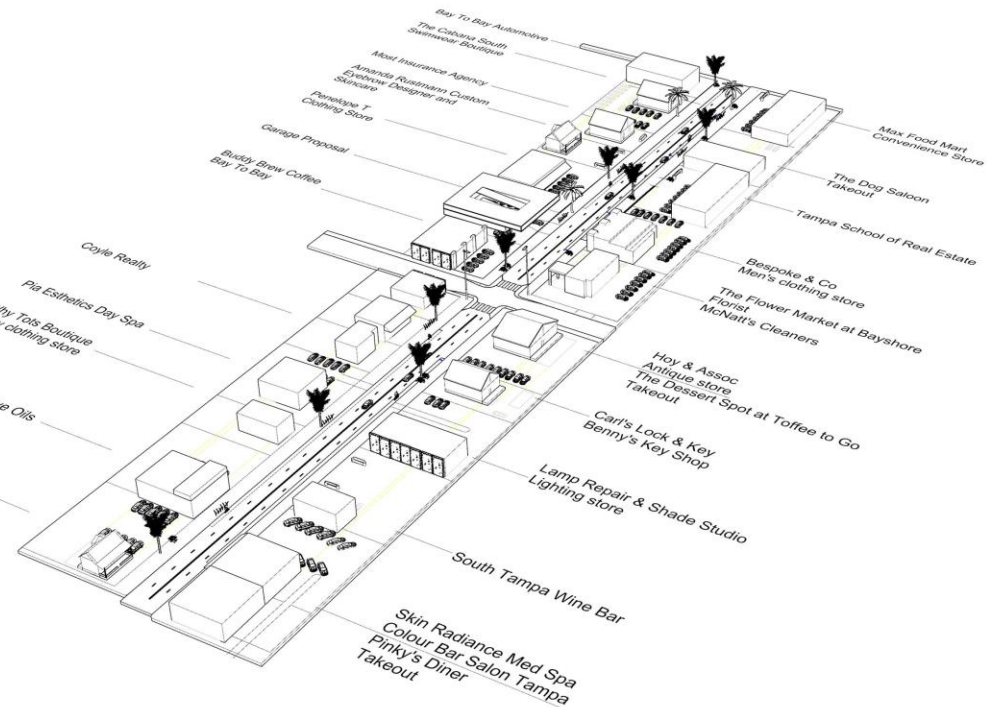
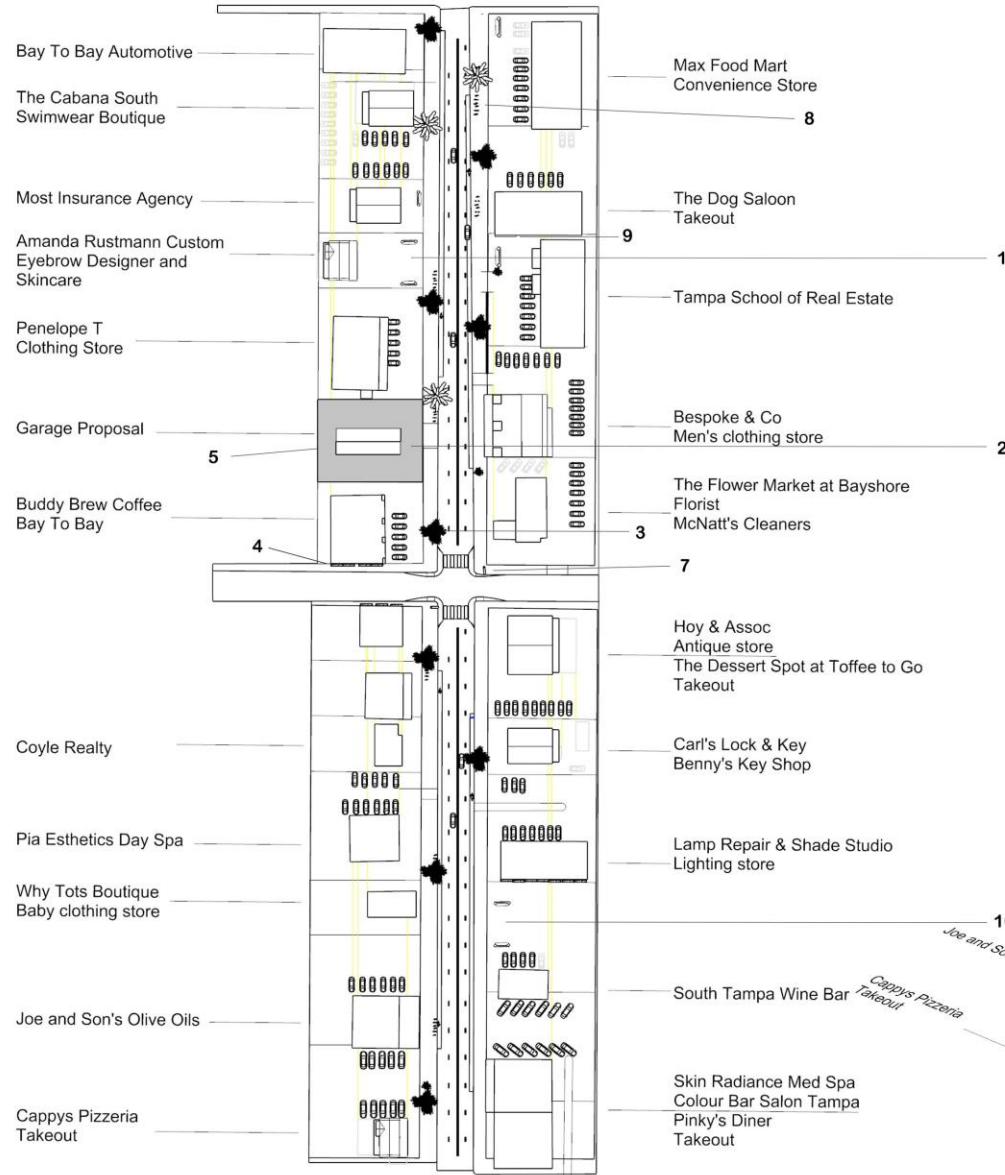

## GARAGE PROPOSAL

Undifferentiated street space and wide travel lanes can result in higher speeds and are an ineffective use of valuable street space.

Converting underutilized travel lanes to other uses can eliminate potential conflicts within the roadway and improve traffic operations.

Raised crosswalks or curb extensions maintain safe travel speeds and reinforce a more safe commercial street.

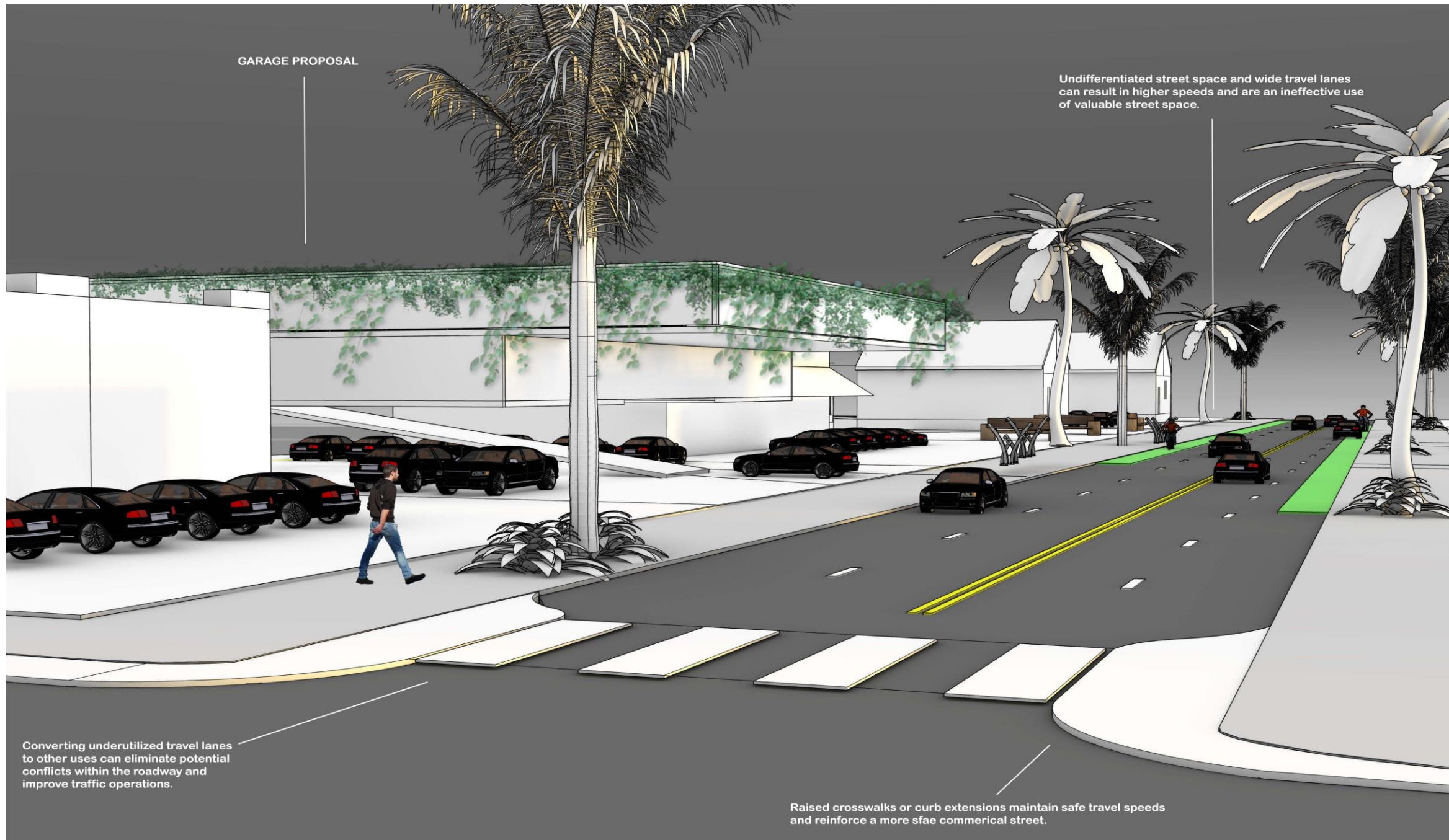



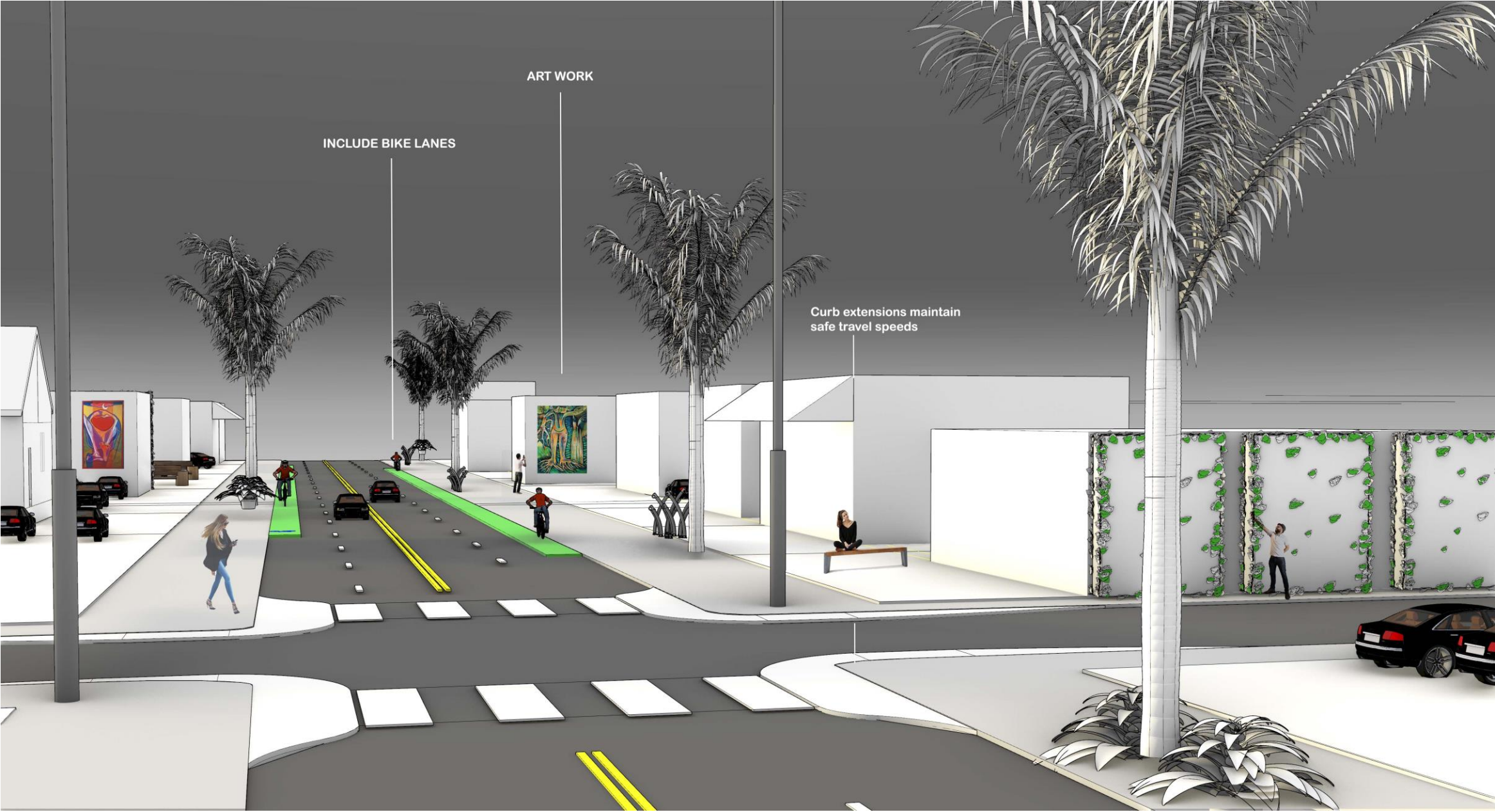

ART WORK

INCLUDE BIKE LANES

Curb extensions maintain  
safe travel speeds

# MacDill







Added a parking space for those only interested in going to the park with shade.

Green areas - creating a area for people to spend time with kids or to having a casual sit down and enjoy the scenery.